

Assembly order:

1. Insert 4 x Interface bracket spacer (Item 4) into Interface bracket in Seat assy (Item 1) as shown in ASSY DETAIL 1-2.
2. Loosen the two grip knobs in the Seat assy (Item 1) (see ASSY DETAIL 1-1).
3. Add a drop of blue Loctite to 4 x threaded holes (see ASSY DETAIL 1-2)
4. Place Backrest (Item 2) between the two Interface brackets in the Seat assy. Fixate in center of brackets and finger tighten the two Grip knobs.
5. Loosen the Cam lever to release the Locking plate (see ASSY DETAIL 2).
6. Insert 4 screws M6x20 (Item 5) and torque to 10 - 12 Nm (see ASSY DETAIL 1-2).
7. Place the assembled Seat/ Backrest unit on top of the Undercarriage (Item 3) and press down to fixate.

REV.	DESCRIPTION	DATE
00	Established	13.03.2017
01	AO edited, Detail View added	03.04.2017
02	Fastener (Item 5) updated	06.11.2017

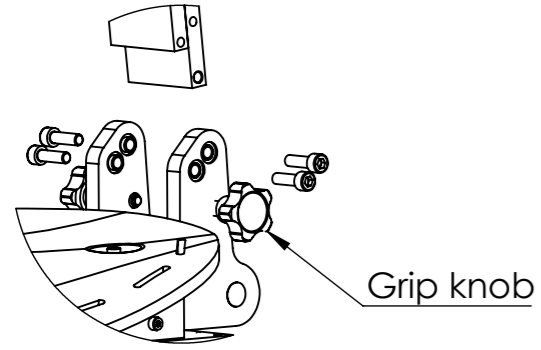
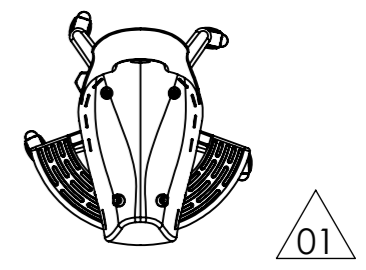
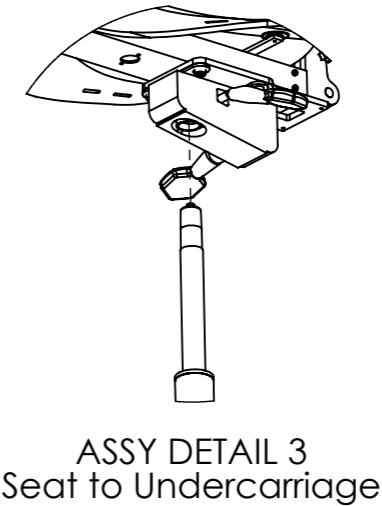
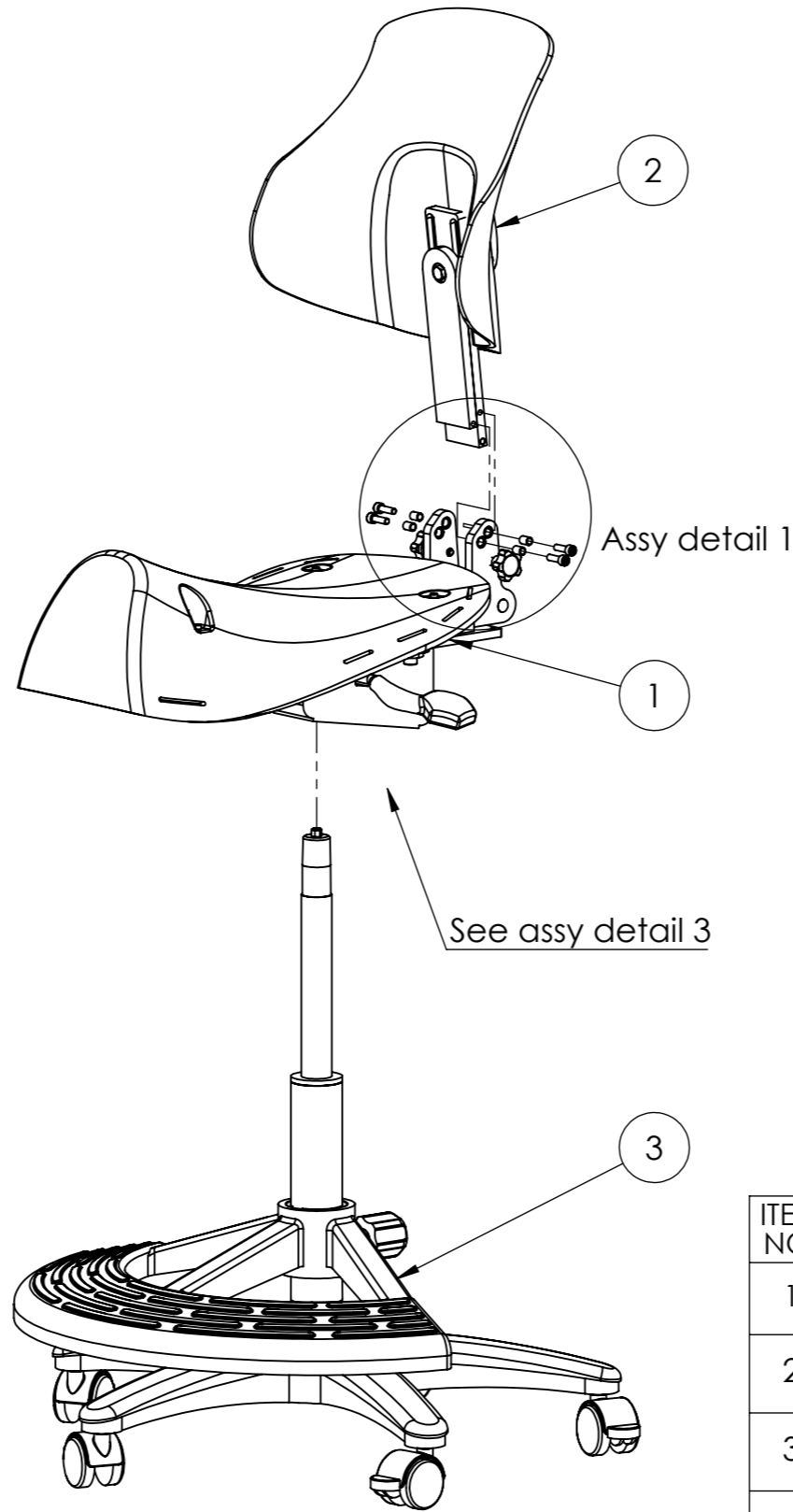

ASSY DETAIL 1-1
Positioning of Backrest

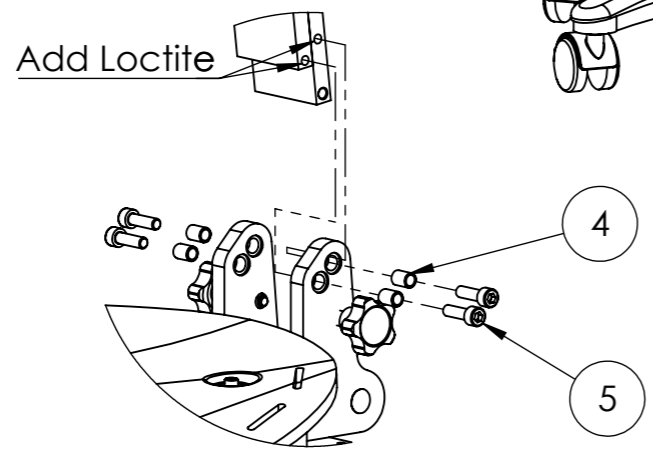

ASSY DETAIL 1-2
Backrest to Seat

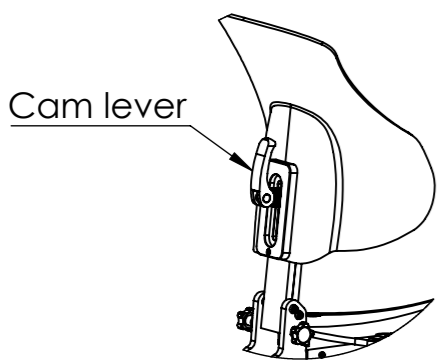

ASSY DETAIL 2

ITEM NO.	PART NUMBER	Title	QTY.
1	300-4010	Krabat Jockey Lite, Seat, complete, size 3	1
2	900-1136	Backrest, high, complete, size 3	1
3	300-4012	Jockey Lite undercarriage, size 3	1
4	900-1140	Interface bracket - spacer	4
5	DIN 912 M6 x 20 --- 20N - St - 10.9 - EZ		4

UNLESS OTHERWISE SPECIFIED:

ALL DIMENSIONS ARE IN MILLIMETERS	TOLERANCES, LINEAR/ ANGULAR: NS-ISO 2768-1-m-K	DEBUR AND BREAK SHARP EDGES	PAPER SIZE: A3	Krabat Jockey	
		MATERIAL:	TREATMENT:		
DRAWN A.S.	SIGNATURE	DATE 13.03.17	FINISH:	DWG NO. 300-4009	REVISION 02
APPV'D			WEIGHT:	SHEET 1 OF 1 SCALE:1:10 DO NOT SCALE DRAWING	